

A) Fixture Run Installation

A.2 Joining Fixture Sections with Screw Type Cable (Cable to Cable: 47-1/4")

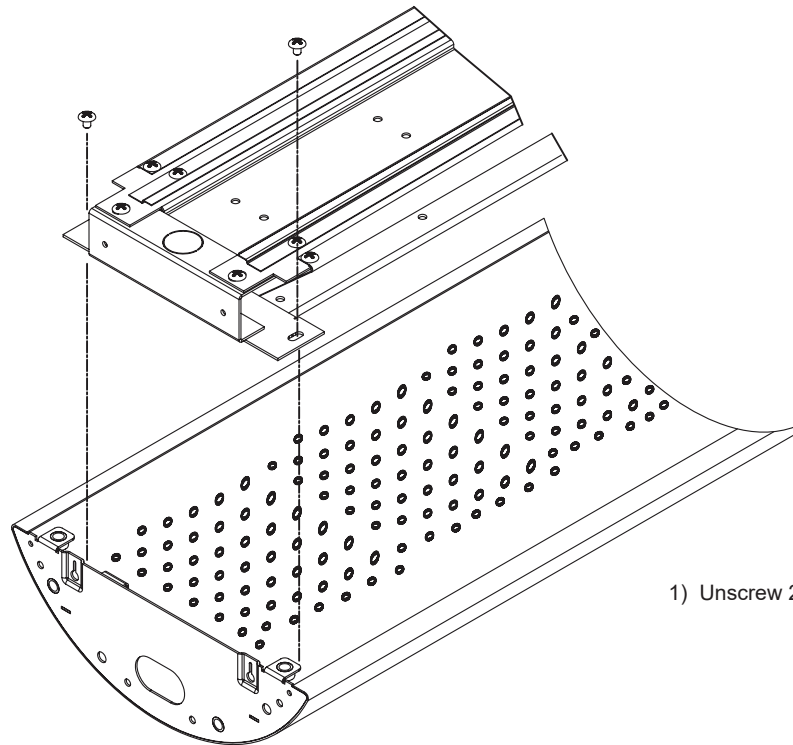

1) Unscrew 2pcs of screws for plate removal.

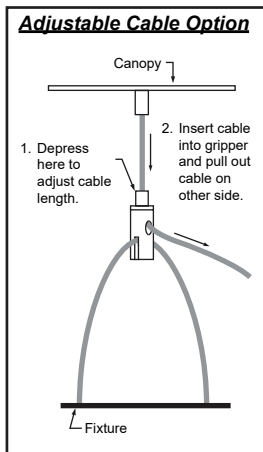
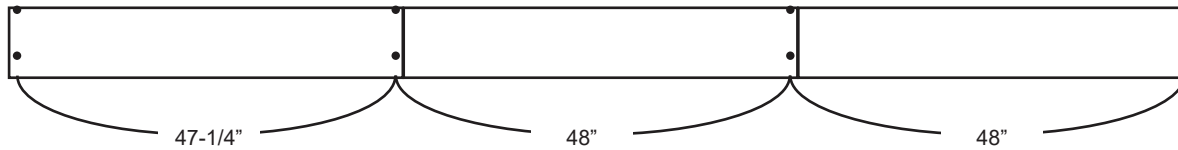

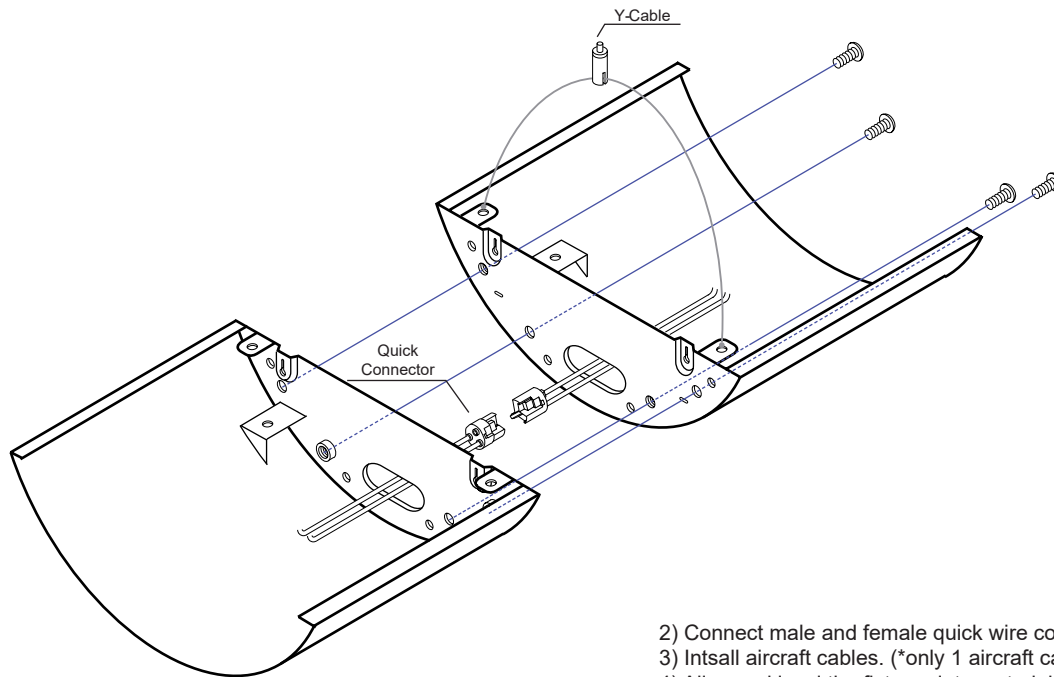

- 2) Connect male and female quick wire connectors.
- 3) Install aircraft cables. (*only 1 aircraft cable at each continuous joint is recommended)
- 4) Align and level the fixtures into a straight row and bolt fixture together.
- 5) Reinstall plate back.

